



West Somerset Railway Heritage Trust.

Registered Charity No. 265564.



**Museum Emergency Plan – Gauge Museum
(Bishops Lydeard).**

STRICTLY CONFIDENTIAL

No of Printed Copies:

THIS DOCUMENT IS NOT CONTROLLED ONCE PRINTED

Location: Printed Copies of this document is kept in the West Somerset Railway Heritage Trust (WSRHT) Office in the Gauge Museum at Bishops Lydeard and in the Blue Anchor Museum. (NOTE: Telephone number 01823 618180 is the WSRHT Office, The Gauge Museum, Platform 1, Bishops Lydeard – this telephone is not always monitored).

NOTE: All telephone names and telephone numbers below are correct at the time of printing; all contact details may change.

FIRST CONTACTS				
Position	Name	Address	Phone	Mobile
WSRHT Chairman	Mike Thompson	West Somerset Railway Heritage Trust The Railway Station Bishops Lydeard Taunton TA4 3BX	01823 618180	07384 307813
Curator	Ian Camp		01823 618180	07961 001291
Archivist	Ian Coleby		01823 618180	07707 451466
Learning and Education Officer	Helen Anson		01823 618180	07856 065032

Contact	Organisation	E-Mail	Phone	Mobile
WSR Duty Officer	For Main Electricity Supply		01643 704996	07525 761791
Kerry Noble (In First Instance)	Insurance			07719 046975
Wrightsure Insurance.				07713 484061
James Ross	WSRHT Electrician		01278 455464	07894 568833
Tim Bridges	WSRHT Electrician	timbridge41@gmail.com	01485 251144	07970 826976
Dave Hole	Plumber			07872 331038

THIS DOCUMENT IS NOT CONTROLLED ONCE PRINTED

Michael Thresher	Glazier	mt@thresherglassandglazing.co.uk	01643 709797	07395 955369
TLS Security Systems Ltd.	Locksmith	sales@tls-security.com		
A&S Security Alarms Ltd.	Burglar Alarms	info@assecurity.co.uk	01460 221137	
A&S Security Alarms Ltd.	CCTV	info@assecurity.co.uk	01460 221137	
H&H Fire Alarms Ltd.	Fire Alarms	info@hhalarms.co.uk	01934 631509	

CONTENTS.

	Page
Introduction:	3
Key Holders.	3
Staff Contacts.	3
Plans of Museum Premises (Gauge Museum, Bishops Lydeard):	
Main Deck and Lower Deck.	4
Upper Deck	5

Introduction.

The WSRHT is committed to taking the best possible care of the Gauge Museum (Bishops Lydeard and Blue Anchor – one museum on two sites), their contents and all those who work or visit there.

This Emergency Plan is designed as an assessment of the potential hazards that could threaten the museum and the actions that could be taken should one occurs. It considers the safety of everyone who works in the building, visitors, objects and the building itself.

This Plan has three aims:

- To identify all of the potential risks to the museum and to make plans to minimise the possible damage.
- To collate all key information in one location, allowing swift and easy access in case of an emergency.
- To provide support in essential decision making during a crisis situation.

The WSRHT is a small Charity looking after the WSR Gauge Museum (Bishops Lydeard and Blue Anchor) and the Heritage Carriages. The Museum and Heritage Carriage volunteers are quite small in numbers and may have to initially fill a number of the Emergency Plan roles until the WSR volunteer force is mobilised.

Key Holders (NOTE: Telephone number 01823 618180 or Mob: 07961 001291 is the WSRHT Office, Platform 1, Bishops Lydeard – these phones are not always monitored).

Name	Address	Phone	Mobile	Comments	
Mike Thompson	West Somerset Railway Heritage Trust The Railway Station Bishops Lydeard Taunton TA4 3BX	01823 412032	07384 307813		
Ian Camp		01823 618180	07961 001291		
Helen Anson		01823 618180	07856 065032		
George Legg		01823 618180	07925 05831		
Station Master (BL) Roger Ellis				07918 816749	
Geoff Evens		01823 618180	07742 655339		
Alison Thornton		01823 433856	?		

Plans of the Museum Premises – Bishops Lydeard, Main and Lower Decks.

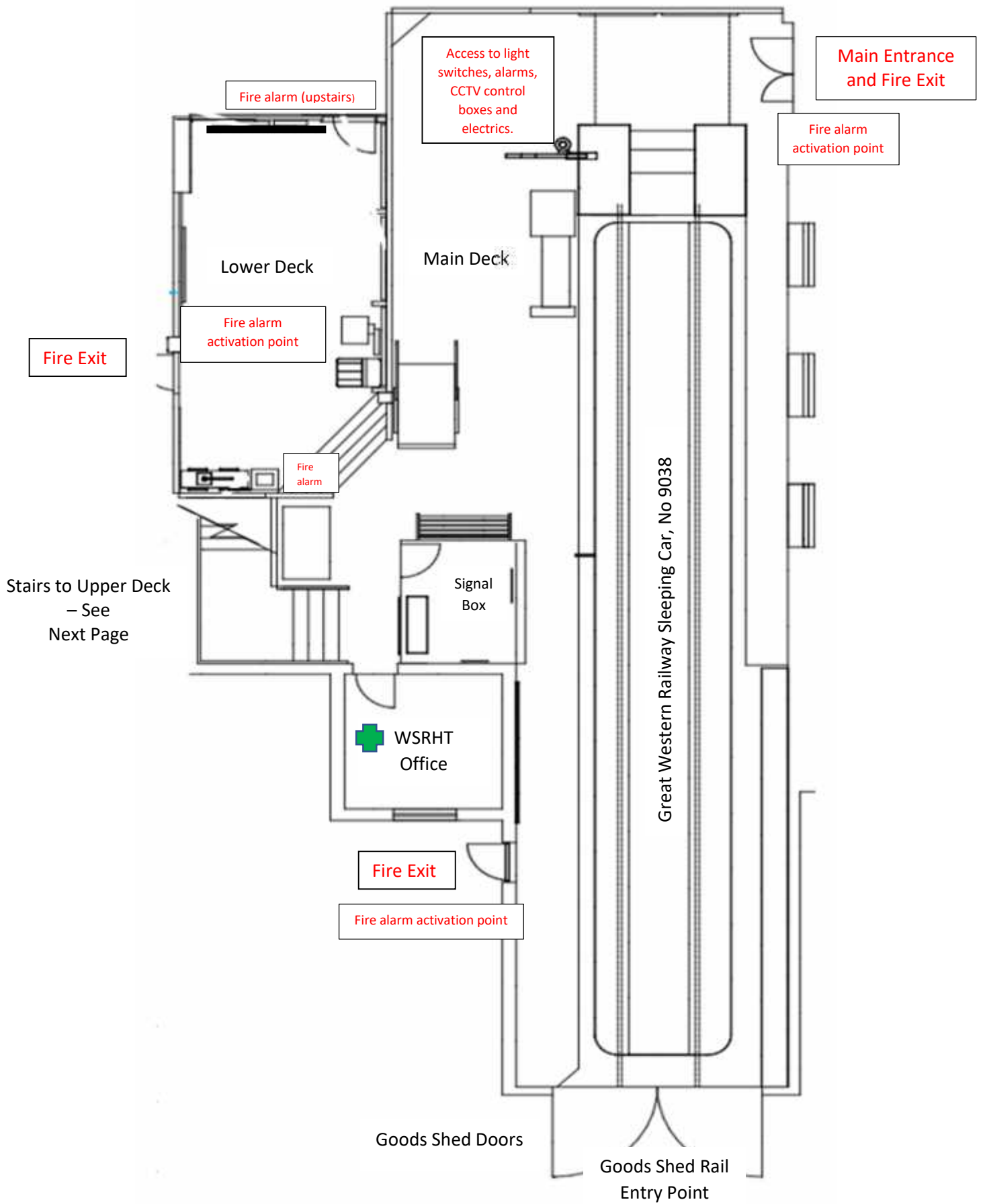

Plans of the Museum Premises – Bishops Lydeard, Upper Deck.

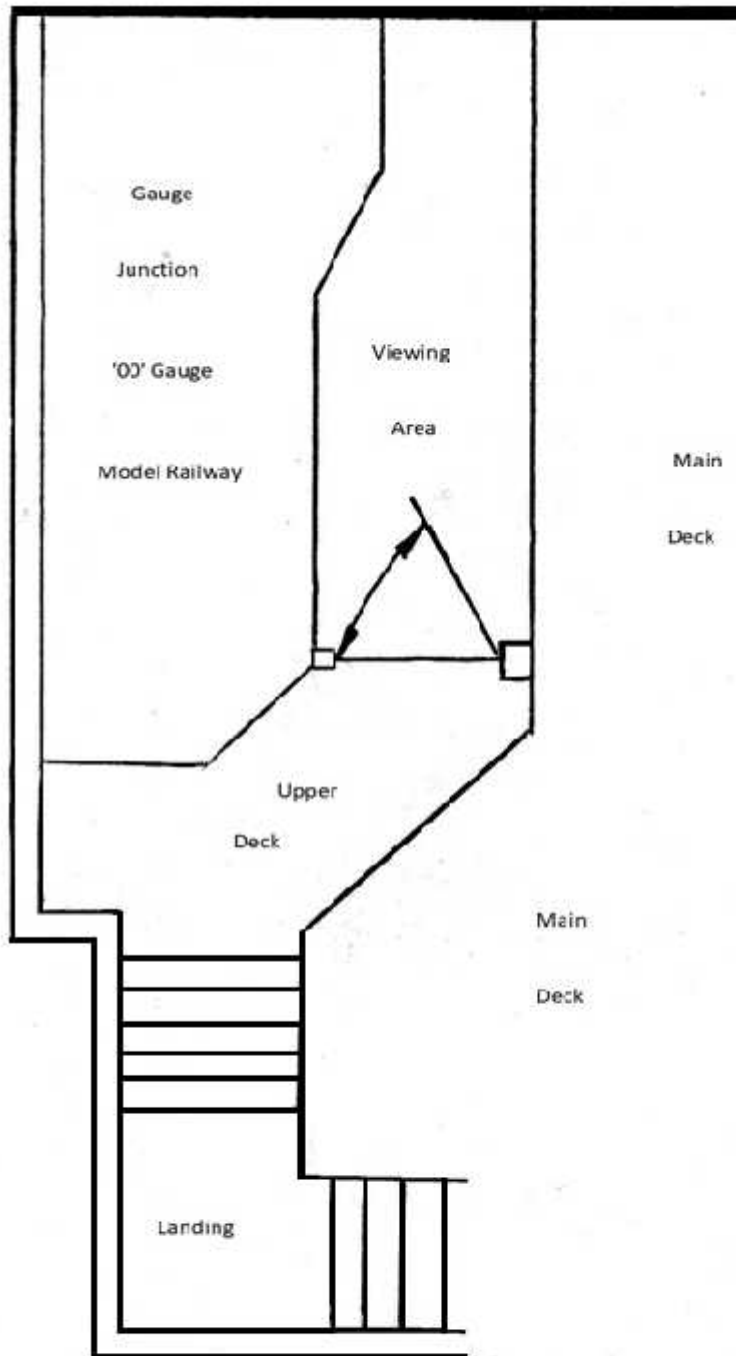

Please Note that 34 additional pages need to be added from the document '*WSRHT Museum Emergency Plan Gauge Museum, Bishops Lydeard-Blue Anchor 3*'.

THIS DOCUMENT IS NOT CONTROLLED ONCE PRINTED